

# Parclo "B" Wrong Way Driving (WWD) Signing Countermeasures

Iowa DOT has implemented this signing treatment at 43 Parclo "B" or "AB" locations in Iowa in 2021



## QUICK FACTS

### Existing Conditions

- Iowa has 55 Parclo "B" or Parclo "AB" interchanges.
- In 2021, 43 of them received enhanced signing and pavement markings.

### Crashes the last 10 years

- Between 2010-2020, there were 36 WWD crashes associated with a Parclo "B" or "AB."
- January 1, 2021 to October 1, 2022, there have been 0 WWD crashes where the POE was from one of these 43 treated interchanges.

### WWD Events Recorded using Video Analytics

- In Summer 2021, cameras with the ability to detect WWD were installed at 7 locations and record constantly.



- Adding all of the months where a camera was monitoring existing conditions and comparing to approximately 18 months of monitoring after enhanced signing was added shows a 93.9% decrease of WWD events.

Interchange	Type of Unique	Camera	# Months "Before" Signing Added *	# WWD Events Before Signing Added	# Months "After" Signing Added	# WWD Events After Signing Added	
I-35 & US-34	Parc-Lo "AB"	WWD55	1	1	18	0	
US-151 & IA-1	Parc-Lo "B"	WWD04	1	1	15	1	
US-30 & C St (WB Exit loop)	Parc-Lo "B"	WWD18	2	2	19	1	
US-30 & C St (EB Exit Loop)	Parc-Lo "B"	WWD19	2	0	19	0	
US-30 & WACONIA AVE/6TH ST SW	Parc-Lo "AB"	WWD09	3	4	18	4	
IA-141 & IA-415	Parc-Lo "AB"	WWD40	1	2	19	0	
US-30 & 19th St	Parc-Lo "AB"	WWD62	6	2	23	0	
* Only the months where the WWD detection camera was installed before signing added.			Totals	16	12	131	6
			Before		After		
			WWD/Month		WWD/Month		
			0.76		0.05		
			94% Decrease		Updated	1/17/2023	

**93.9%** ↓

DECREASE IN WWD EVENTS

Pavement marking shown are for Information only.  
Refer to Standard Road Plans for additional details.

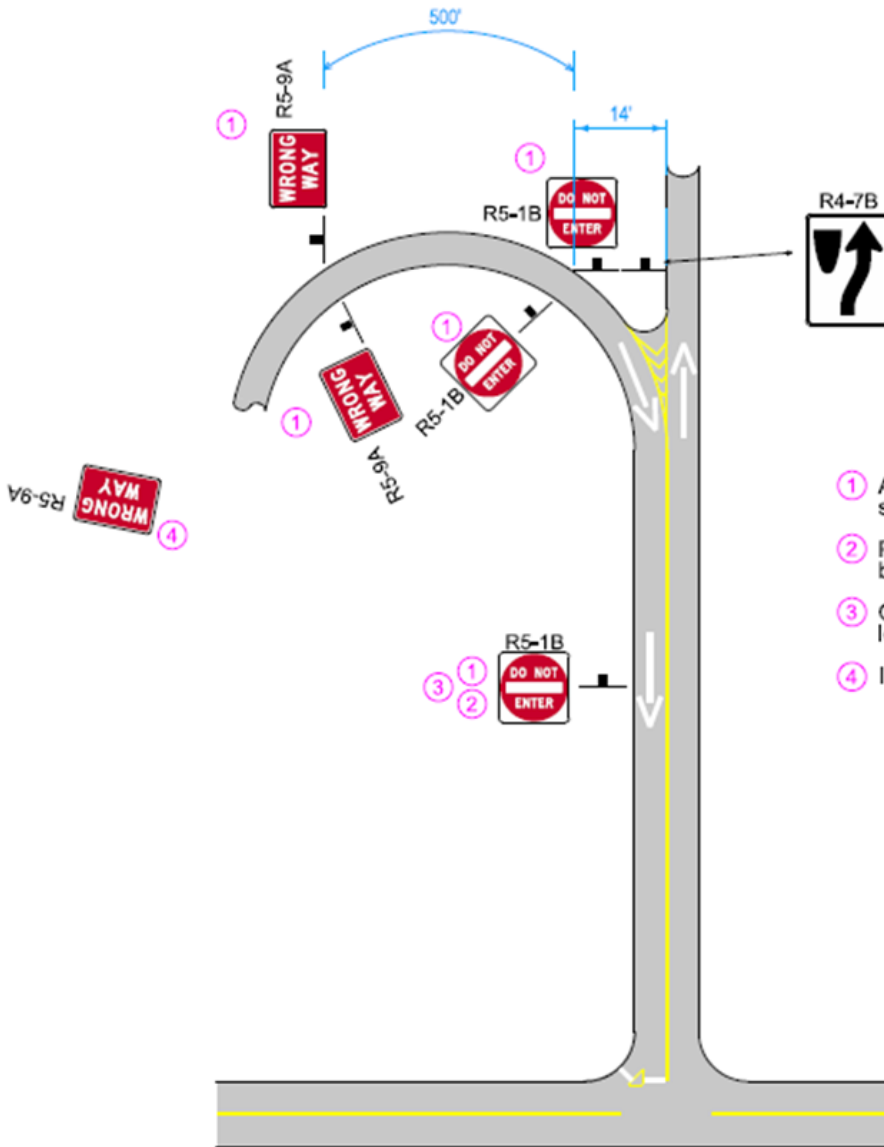

- ① Add 2" red Conspicuity Tape on legs on sign posts
- ② Place Do Not Enter sign half the distance between Intersection and beginning of curve
- ③ Omit midpoint Do Not Enter sign If throat length is less than 400 feet
- ④ Install Wrong Way sign on back of exit gore sign

SPECIAL MOUNTING BRACKETS	
Type	Quantity
Auxillary Mounting Bar	10
TOTALS	10

TYPE 'A' SIGNS		
Sign Number	Sign Size	Number of Signs
R4-7B	36 x 48	1
R5-1B	48 x 48	3
R5-9A	42 x 30	3
TOTALS		7

PSST POSTS FOR SIGNS		
Quantity	Post Length	Total
6	15	90
TOTALS		90

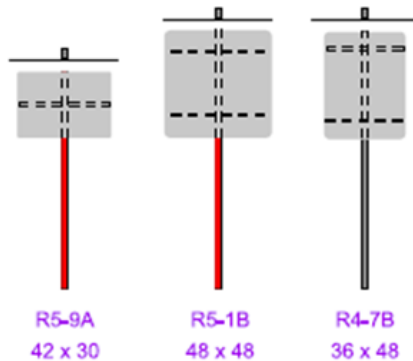

- Mount sign(s) on a single post
- Mount sign(s) on two posts

<b>IOWADOT</b>	REVISION	
	3	11-03-20
<b>INTERSECTION CONTROL SIGNING TYPICAL</b>	<b>IC-430a</b>	
	TAS STANDARD	
REVISION: <u>3</u>		
<b>ENHANCED SIGNING FOR IDENTIFIED WRONG WAY DRIVING LOCATIONS</b>		
<b>FOR PARTIAL CLOVERLEAF INTERCHANGE</b>		